

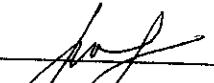



Drain: ABEL L HAUGHEY Drain #: 138
 Improvement/Arm: RECONSTRUCTION
 Operator: J. L. Livingston Date: 1-7-03
 Drain Classification: Urban/Rural Year Installed: 1995

GIS Drain Input Checklist

- Pull Source Documents for Scanning
- Digitize & Attribute Tile Drains
- Digitize & Attribute Storm Drains
- Digitize & Attribute SSD
- Digitize & Attribute Open Ditch
- Stamp Plans
- Sum drain lengths & Validate
- Enter Improvements into Posse
- Enter Drain Age into Posse
- Sum drain length for Watershed in Posse
- Check Database entries for errors

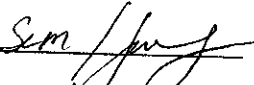
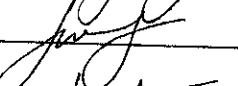
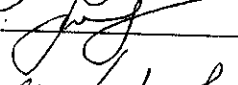

Gasb 34 Footages for Historical Cost Drain Length Log

Drain-Improvement: _____

Drain Type:	Size:	Length ()	Length (DB Query)	Length Reconcile	If Applicable	
					Price:	Cost:
TILE - PLASTIC	12"	598'	598'			
OPEN DITCH	—	328'	328'			

Sum: 926' 926' \$15395

Final Report: 926'

Comments:

Hearing 6/5/95 - 6:10pm

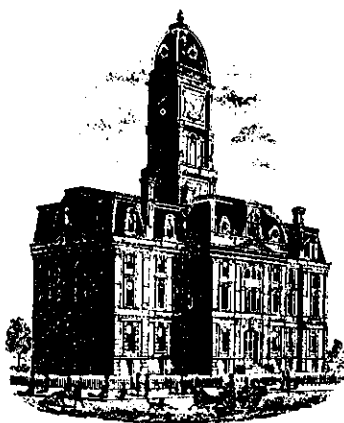

SURVEYOR'S OFFICE Hamilton County

Kenton C. Ward, Surveyor Suite 146
776-8495 One Hamilton County Square
Noblesville, Indiana 46060-2236 April 20, 1995

TO: Hamilton County Drainage Board

RE: A. L. Haughey Drain

Attached is a petition for the reconstruction of the A. L. Haughey Drain along with plans for the proposed work.

The proposed Haughey Drain reconstruction consists of the following items:

Grass Waterway	650 feet @ \$1.50/ft	\$ 975.00
Rock Chute	1 @ \$2500.00 each	2,500.00
Clearing	0.5ac @ \$1500/ac	750.00
Seeding	1.0ac @ \$1000.00/ac	1,000.00
12" Tile	630 feet @ 9.50/ft	5,985.00
15" CMP	20 feet @ \$21.00/ft	420.00
Silt Basin	1 @ \$200.00 each	200.00
15" Animal Guard	1 @ \$63.00 each	63.00
Dredging	350ft @ \$4.50/ft	1,575.00
2x2 Box w/grate	1 @ \$800.00 each	800.00
	Sub Total	\$14,268.00
	10% Contg.	1,427.00
	TOTAL	\$15,695.00

This would replace the existing tile at or near STA 10, West of Dunbar Road with a twelve (12") inch concrete Tile. At this location will be a 2x2 Concrete Box used to intercept the existing tile. The new tile will also include a waterway along its 650 foot length. At or near STA 16+50 of the original Drain (STA 6+50 on proposed plan) a rock chute will be installed and between this point and Little Cicero Creek, an open ditch will be installed. Along the Top of Bank of the Open Ditch will be a twenty (20') foot Grass Filter Strip. This reconstruction will add 200 feet to the drain length, increasing the length from 1800 feet to 2000 feet.

The drainage shed has 110.5 acres. Upon consideration of each parcel individually, I believe that each parcel will have equal benefits as provided by the proposed reconstruction. Therefore, I recommend the Board assess the benefited parcels at a rate of \$142.04/an acre, with a minimum of \$200.00. I also believe that damages should be at \$0.00 for each parcel.

This drain was placed on maintenance in 1981 at a rate of \$2.00/ac, \$3.00 minimum and now collects \$224.00 annually. At this time the drain is \$1,130.00 in the Red. I recommend the maintenance assessment be increased to \$5.00 per acre, with a \$10.00 minimum, which would increase the annual maintenance assessment to \$ *565.00*

I recommend a hearing be set for this proposal in June 1995.

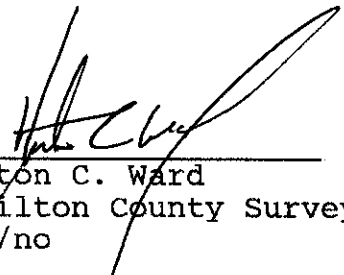

Kenton C. Ward
Hamilton County Surveyor
KCW/no

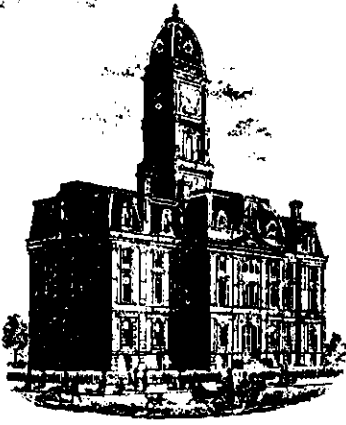

SURVEYOR'S OFFICE
Hamilton County

Kenton C. Ward, Surveyor

Suite 146

776-8495

One Hamilton County Square,

Noblesville, Indiana 46060-2230

January 5, 1996

TO: Hamilton County Drainage Board

RE: A. L. Haughey Drain

On November 9, 1995, the final inspection was made for the A. L. Haughey Drain. The final inspection was done by Stephen R. Mosbaugh of my office. At this time the work was found to be complete and acceptable. The reconstruction was done by John Ward Construction under contract dated July 21, 1995.

The contract price was \$14,945 and the project estimate on my original report dated April 20, 1995 was \$15,655.00. The project cost including change orders, reductions, and the bid amount was totaled at \$15,395.00. The result being that the project was \$300.00 under estimate. The changes occurring in construction and cost are as follows:

CHANGE ORDER #1

By order of Hamilton County Surveyor due to soil conditions encountered during construction the decision was made to install twelve (12") inches corrugated plastic sock type tile in place of twelve (12") inch concrete pipe at a difference of an additional \$450.00. Supplementary bid prices were included in the contract and are on file in the Hamilton County Surveyor's Office.

Page #2

The length of the drain is now 1,926 feet.

The payments to the Contractor are as follows:

<u>Claim Date:</u>	<u>Claim Number:</u>	<u>Claim Amount:</u>
December 5, 1995	96-008	\$13,085.75

At this time all but the fifteen (15%) percent retainage has been paid. This amount is \$2,309.25. The Contractor has submitted a statement for expenses and cost as required.

I recommend the Board accept the drain as complete and acceptable and approve the final payment.

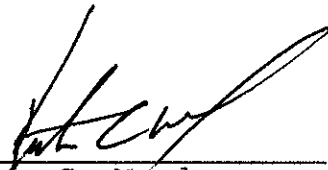

Kenton C. Ward
Hamilton County Surveyor
KCW/no *SLM*

PLAN
NOTE BOOK
No.

PROFILE
NOTE BOOK
No.

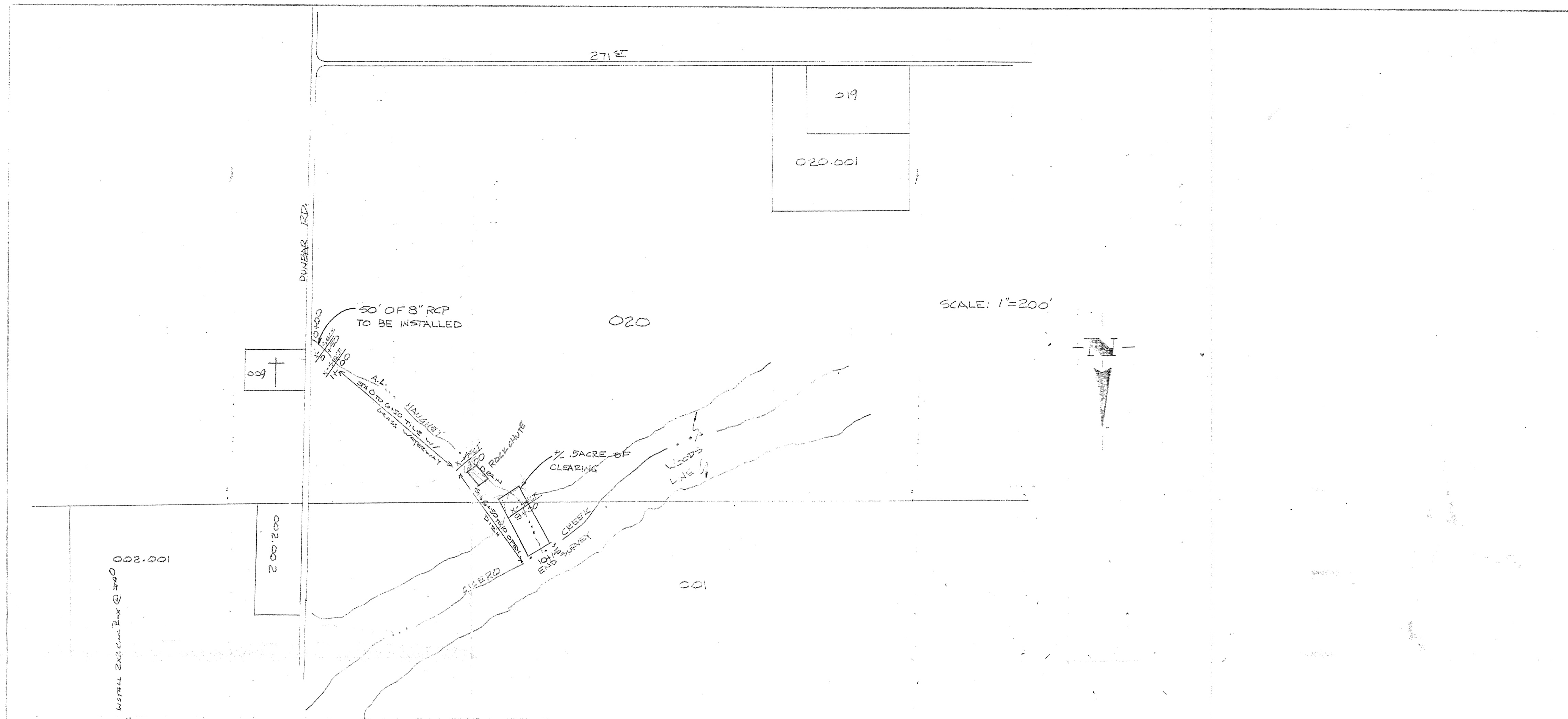

R-4353 Beehive Grate with Frame
 Medium Duty
 Total Weight 210 pounds

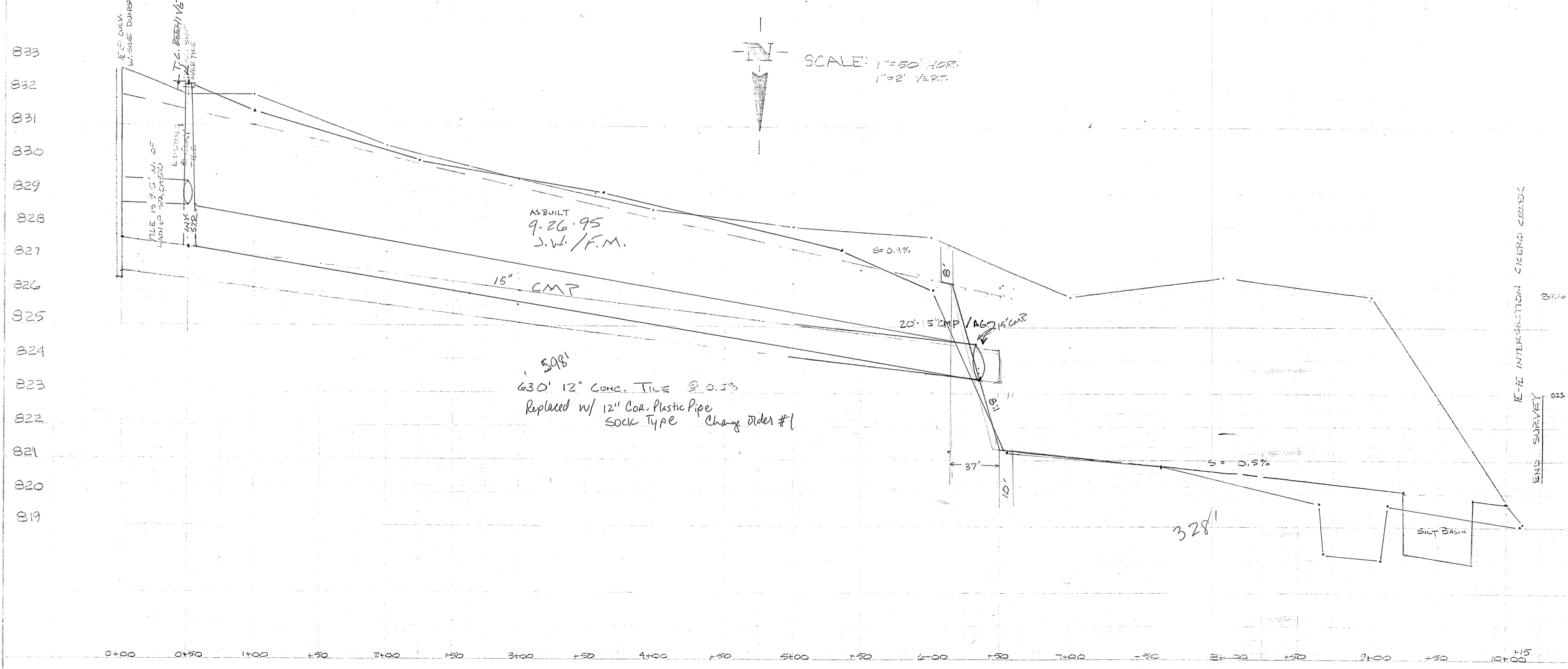

BENCH MARKS

TBM 1: CENTER OF THE WEST HEADWALL OF CULVERT ON DUNBAR OVER THE A.L. HAUGHEY ELEV.: 838.31

TBM 2: PK NAIL IN 14" TREE ON THE WEST SIDE OF EXISTING CHANNEL ±40' NEAR STA. 10+00. ELEV.: 825.29

MILTON COUNTY INDIANA
 1823

This information was gathered for input into the Hamilton County Geographical Information System. This document is considered an official record of the GIS.

Entry Date: 1-7-03
 Entered by: *scm/jug*

UP-SLOPE
 DOWN-SLOPE

6' TOT 8:1
 4' BOTTOM
 110%.